

- Smart Positioner
- Electro-Pneumatic Positioner
- Pneumatic-Pneumatic Positioner
- Volume Booster
- Air Filter Regulator
- Lock Up Valve
- Snap Acting Relay
- Solenoid Valve
- Electro Position Transmitter
- Limit Switch



## Contents

History		3	
Certifications		4,5	
	<i>Products</i>		
• Smart Positioner		6	YT-2300 Series
		7	YT-2350 Series(Stainless Steel Type)
		8	YT-2301L (Remote Type)
		9	YT-2301R (Remote Type)
		10	YT-2400 Series (Explosion Proof Type)
• Electro-Pneumatic Positioner		11	YT-1300 Series (Analog Type)
		12	YT-1350 Series (Stainless Steel Analog Type)
		13	YT-1000L
		14	YT-1000R(Standard)
		15	YT-1000R(Dome Cover)
	Linear Type	16	YT-1000R + PTM (Internal)
	Rotary Type	17	YT-1000R + PTM (External)
		18	YT-1000R + L/S (Internal)
		19	YT-1000R + L/S (External)
		20	YT-1000R + PTM + L/S (Internal)
		21	YT-1000R + PTM + L/S (External)
• Pneumatic-Pneumatic Positioner	Linear Type	22	YT-1200L
	Rotary Type	23	YT-1200R
• Air Filter Regulator		24	YT-200, YT-205
• Volume Booster		25	YT-300, YT-305, YT-310, YT-315
• Lock Up Valve		26	YT-400
• Snap Acting Relay		27	YT-500, YT-505, YT-510, YT-515
• Solenoid Valve		28	YT-700
• Position Transmitter		29	PTM-5VL,R
		30	PTM-6VL,R (Flameproof Type)
		31	PTM-6VR + L/S (Flameproof Type)
• Limit Switch		32	YT-850
		33	YT-860 (Flameproof Type)
• Bracket,Lever		34	
		35	

## History

1996.01	Established Young Tech Co., Ltd.
1996.05	Produced the Electro-Pneumatic positioner YT-1000L, R
1996.08	Produced the Air Filter Regulator YT-200, 220
1997.01	Certified Explosion proof (ExsdIIBT6) on E/P positioner YT-1000L, R
1997.07	Produced the Volume Booster YT-300
1997.12	Produced the Pneumatic-Pneumatic positioner YT-1200L, R
1998.02	Produced the Position Transmitter PTM-5L, R
1998.04	Certified Explosion proof (ExdmIIBT5) on E/P positioner YT-1000L, R
1998.08	Certified CE on E/P positioner YT-1000L, R
1998.09	Certified Explosion proof (ExdmIIBT5) on E/P positioner YT-1000L, R
1999.04	Produced the smart positioner YT-2000L, R
1999.06	Produced the Volume Booster YT-310
1999.10	Certified EM (Excellent Machine, Mechanism & Materials) on E/P positioner YT-1000L, R
2000.01	Certified ISO 9001
2000.04	Certified Venture Business (from Korean Government)
2000.07	Produced the Lock Up Valve YT-400
2000.11	Produced the Snap Acting Relay YT-500, YT-510
2001.01	Produced the Position Transmitter PTM-6L, R
2001.03	Certified Explosion proof (ExdIICT6) on Position Transmitter PTM-6L, R
2001.05	Completed new factory
2001.08	Certified KEMA on E/P positioner YT-1000L, R (EExmdIIBT4)
2001.11	Certified explosion proof (ExdIICT6) on solenoid valve YT-700, 710, 720
2002.02	Started to produce EA91, EA90 by OEM for Motoyama Eng. Works, Ltd.
2002.05	Joined in Hart Foundation
2002.07	Certified export-oriented small and medium-sized company (From Korean Government)
2002.09	Produced stainless steel type Air filter regulator YT-250
2003.02	Upgraded to ISO 9001:2000
2003.03	Certified explosion proof (ExdIICT6) on smart positioner YT-2200L, R
2003.10	Certified ATEX explosion proof(EEx dm IIB T5)on E/P positioner YT-1000
2003.11	Produced the smart positioner YT-2300L,R
2004.01	Established laboratory
2004.01	Produced the position transmitter PTM-5V,PTM-6V series
2004.11	Produced the smart positioner YT-2400L,R
2005.01	Certified CSA explosion proof Ex md IIBT5 on E/P positioner series YT-1000.m..
2005.01	Certified JIS explosion proof IIB T5 on E/P positioner YT-1000 series
2005.01	Produced the Electro-pneumatic positioner YT-1300L,R
2005.08	Produced the stainless steel smart positioner YT-2350,E/P positioner YT-1350 series
2005.12	Produced the remote type smart psitioner YT-2301series



## Certifications



TUV ISO9001



CE (YT-1000L,R)



Proof of Venture Business



ATEX (YT-1000L,R)

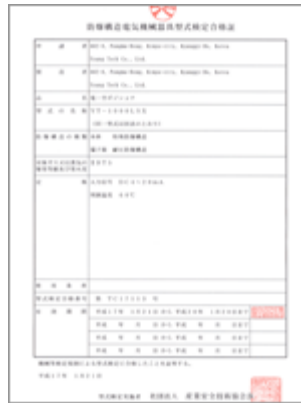

JIS (YT-1000L,R)



CSA (YT-1000L,R)



EM-Excellent Machine  
Mechanise&Materials



HART Membership



Patent (YT-1000L,R)

# Certification



Ex ia IIB T6 (YT-1000L,R)



Ex dm IIB T6 (YT-1000L,R)



Ex dm IIC T6 (YT-1000L,R)



Ex ia IIC T6 (YT-2300L,R)



Ex d IIB T6+H2 (YT-2400L,R)



Ex ia IIC T6 (PTM-5V Series)



Ex d IIC T6 (PTM-6V Series)



Ex d IIC T6 (YT-700)



Ex ia IIB T6 (YT-1300L,R)

## Smart Positioner YT-2300 Series

Ordering Symbols: YT-2300

Model	Motion	Acting Type	Explosion Proof	Lever Type	Connection Type	Communication	Option	
YT-2300	<span style="border: 1px solid purple; padding: 2px;">L</span> Linear	<span style="border: 1px solid orange; padding: 2px;">S</span> Single Acting	<span style="border: 1px solid green; padding: 2px;">r</span> Non-Explosion	<span style="border: 1px solid blue; padding: 2px;">1</span> 10~40mm	<span style="border: 1px solid blue; padding: 2px;">1</span> M6×40L	<span style="border: 1px solid blue; padding: 2px;">1</span> PT	<span style="border: 1px solid green; padding: 2px;">○</span> NONE	<span style="border: 1px solid gray; padding: 2px;">○</span> NONE
	<span style="border: 1px solid purple; padding: 2px;">R</span> Rotary	<span style="border: 1px solid orange; padding: 2px;">D</span> Double Acting	<span style="border: 1px solid green; padding: 2px;">E</span> ExialICT6	<span style="border: 1px solid blue; padding: 2px;">2</span> 20~70 mm	<span style="border: 1px solid blue; padding: 2px;">2</span> M6×63L	<span style="border: 1px solid blue; padding: 2px;">2</span> NPT	<span style="border: 1px solid green; padding: 2px;">□</span> HART	<span style="border: 1px solid gray; padding: 2px;">1</span> +Transmitter
				<span style="border: 1px solid blue; padding: 2px;">3</span> 50~100 mm	<span style="border: 1px solid blue; padding: 2px;">3</span> M8×40L			
				<span style="border: 1px solid blue; padding: 2px;">4</span> 100~150 mm	<span style="border: 1px solid blue; padding: 2px;">4</span> M8×63L			
					<span style="border: 1px solid blue; padding: 2px;">5</span> NAMUR			



### Specifications

Item.Type	YT-2300L	YT-2300R
Input Signal	4-20mA DC	
Supply Pressure	1.4~7kgf/cm <sup>2</sup> (0.14~0.7MPa)	
Stroke	10~150mm	0~90°
Impedance	Max.460 Ohm/20mA DC	
Air Connection	PT (NPT) 1/4	
Gauge Connection	PT (NPT) 1/8	
Conduit	PF 1/2 (G1/2)	
Repeatability	±0.3%F.S.	
Ambient Temp	Operating	-40~85 °C (-40~185°F)
	Explosion	-40~60 °C (T5)/-40~40 °C (T6)
Linearity	±0.5% F.S.	
Hysteresis	±0.5% F.S.	
Sensitivity	±0.2% F.S.	
Air Consumption	Below 2LPM(sup=1.4K)	
Flow Capacity	70LPM	
Output Characteristics	Linear, EQ%, Quick Open User set(16Point)	
Material	Aluminum Diecasting	
Protection	IP66	
Explosion Proof	ExialICT6	
Weight	1.5kg(3.3lb)	

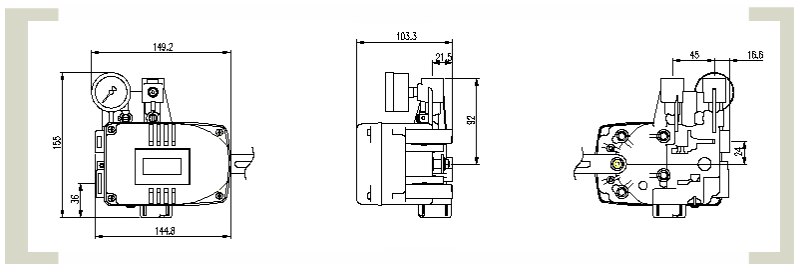

YT-2300 Smart Valve Positioner controls valve stroke accurately according to input signal of 4-20mA being input from controller. In addition, highly efficient microprocessing operator built in the product performs various and powerful functions like Auto calibration, PID control, Alarm and Hart protocol.

- LCD attached outside of the product makes to inspect the state of positioner in the field.
- All kinds of information for valve and positiner can be processed with using Hart communication.
- Valve system can be stable by outputting analog feedback signal.
- Various valve characteristics such as linear, quick open , equal percentage are available.
- PID parameters can be adjusted easily in the field only by button without communicator.
- It has the protection grade of IP 66.

## Smart Positioner YT-2350 Series

Ordering Symbols: YT-2350

Model	Motion	Acting Type	Explosion Proof	Lever Type	Connection Type	Communication	Option	
YT-2350	<span style="border: 1px solid purple; padding: 2px;">L</span> Linear	<span style="border: 1px solid orange; padding: 2px;">S</span> Single Acting	<span style="border: 1px solid green; padding: 2px;">r</span> Non-Explosion	<span style="border: 1px solid blue; padding: 2px;">1</span> 10~40mm	<span style="border: 1px solid blue; padding: 2px;">1</span> M6×40L	<span style="border: 1px solid blue; padding: 2px;">1</span> PT	<span style="border: 1px solid green; padding: 2px;">○</span> NONE	<span style="border: 1px solid gray; padding: 2px;">○</span> NONE
	<span style="border: 1px solid purple; padding: 2px;">R</span> Rotary	<span style="border: 1px solid orange; padding: 2px;">D</span> Double Acting	<span style="border: 1px solid green; padding: 2px;">E</span> ExialICT6	<span style="border: 1px solid blue; padding: 2px;">2</span> 20~70 mm	<span style="border: 1px solid blue; padding: 2px;">2</span> M6×63L	<span style="border: 1px solid blue; padding: 2px;">2</span> NPT	<span style="border: 1px solid green; padding: 2px;">□</span> HART	<span style="border: 1px solid gray; padding: 2px;">1</span> +Transmitter
				<span style="border: 1px solid blue; padding: 2px;">3</span> 50~100 mm	<span style="border: 1px solid blue; padding: 2px;">3</span> M8×40L			
				<span style="border: 1px solid blue; padding: 2px;">4</span> 100~150 mm	<span style="border: 1px solid blue; padding: 2px;">4</span> M8×63L			
					<span style="border: 1px solid blue; padding: 2px;">5</span> NAMUR			



### Specifications

Item.Type	YT-2350L	YT-2350R
Input Signal	4-20mA DC	
Supply Pressure	1.4~7kgf/cm <sup>2</sup> (0.14~0.7MPa)	
Stroke	10~150mm	0~90°
Impedance	Max.460 Ohm/20mA DC	
Air Connection	PT (NPT) 1/4	
Gauge Connection	PT (NPT) 1/8	
Conduit	PF 1/2 (G1/2)	
Repeatability	±0.3%F.S.	
Ambient Temp	Operating	-40~85 °C (-40~185°F)
	Explosion	-40~60 °C (T5)/-40~40 °C (T6)
Linearity	±0.5% F.S.	
Hysteresis	±0.5% F.S.	
Sensitivity	±0.2% F.S.	
Air Consumption	Below 2LPM(sup=1.4K)	
Flow Capacity	70LPM	
Output Characteristics	Linear, EQ%, Quick Open User set(16Point)	
Material	Stainless Steel 316	
Protection	IP66	
Explosion Proof	ExialICT6	
Weight	3.7kg(8.16lb)	

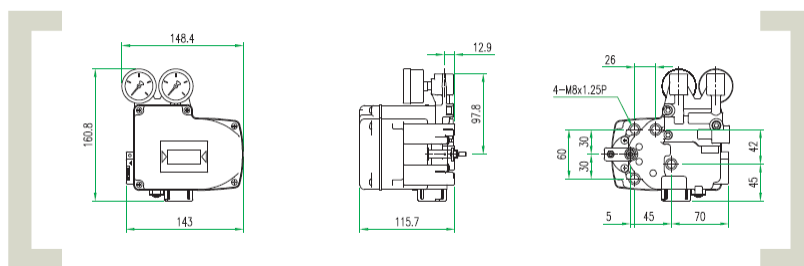

YT-2350 Smart Valve Positioner controls valve stroke accurately according to input signal of 4-20mA being input from controller. In addition, highly efficient microprocessing operator built in the product performs various and powerful functions like Auto calibration, PID control, Alarm and Hart protocol.

- LCD attached outside of the product makes to inspect the state of positioner in the field.
- All kinds of information for valve and positiner can be processed with using Hart communication.
- Valve system can be stable by outputting analog feedback signal.
- Various valve characteristics such as linear, quick open , equal percentage are available.
- PID parameters can be adjusted easily in the field only by button without communicator.
- It has the protection grade of IP 66.

## Smart Positioner YT-2301L (Remote Type)

Ordering Symbols: YT-2301L

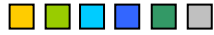

Model	Acting Type	Explosion Proof	Lever Type	Connection Type	Communication	Option
YT-2301L	Single Acting	Non-Explosion	10~40mm	PT	NONE	NONE
	Double Acting	ExiallCT6	20~70 mm 50~100 mm 100~150 mm	NPT	HART	+ Transmitter



### Specifications

Item.Type	Single	Double
Input Signal	4-20mA DC, 4-12mA DC	
Supply Pressure	1.4~7kgf/cm <sup>2</sup> (0.14~0.7MPa)	
Stroke	10~150mm	
Impedance	Max 460 Ohm/20mA DC	
Air Connection	PT (NPT) 1/4	
Gauge Connection	PT (NPT) 1/8	
Conduit	PF 1/2 (G1/2)	
Repeatability	±0.3% F.S.	
Sensor Operating Temp.	-40~120 °C (-40~248 °F)	
Body Operating Temp.	-40~85 °C (-22~185 °F)	
Explosion Temp.	-40~60 °C (T5)/-40~40 °C (T6)	
Linearity	±0.5% F.S.	
Hysteresis	±0.5% F.S.	
Sensitivity	±0.2% F.S.	
Air Consumption	Below 2LPM(sup=1.4K)	
Flow Capacity	70LPM	
Output Characteristics	Linear, EQ%, Quick Open User set(16Point)	
Material	Aluminum Diecasting	
Protection	IP66	
Explosion Proof	ExiallCT6	
Weight	Body	1.5kg(3.3lb)
	Sensor	0.6kg(1.3lb)

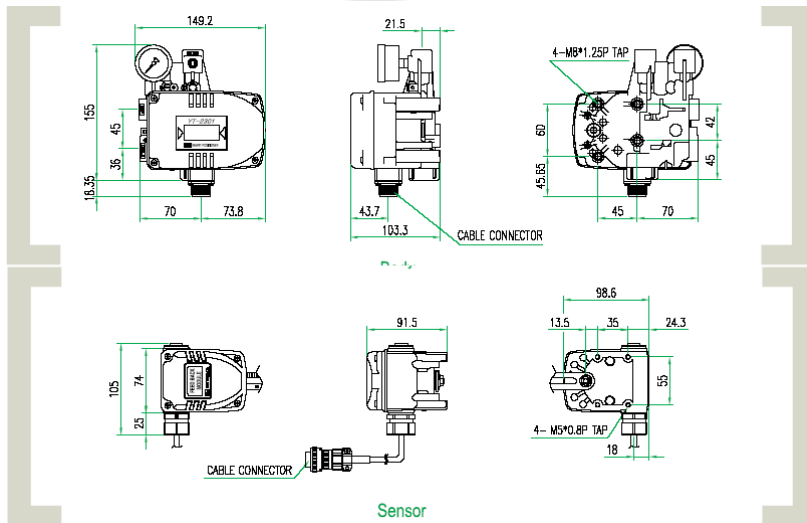

Smart positioner YT-2301L is supplying additional Remote Function into all the exist smart operation and have higher reliability and convenience in the circumstances of high temperature & vibrations by installed feedback sensors in Controlvalve and Positioners in requested places.

- Available Installation separately Feedback senser parts from the Positioner body itself.
- LCD attached outside of the product makes to inspect the state of positioner in the field.
- All kinds of information for valve and positiner can be processed with using Hart communication.
- Valve system can be stable by outputting analog feedback signal.
- Various valve characteristics such as linear, quick open , equal percentage are available.
- PID parameters can be adjusted easily in the field only by button without communicator.



## Smart Positioner YT-2301R (Remote Type)

Ordering Symbols: YT-2301R

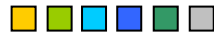

Model	Acting Type	Explosion Proof	Lever Type	Connection Type	Communication	Option
YT-2301R	Single Acting	Non-Explosion	M6×40L	PT	NONE	NONE
	Double Acting	ExiallCT6	M6×63L	NPT	HART	+ Transmitter
			M8×40L			
			M8×63L			
			NAMUR			



### Specifications

Item.Type	Single	Double
Input Signal	4-20mA DC, 4-12mA DC	
Supply Pressure	1.4~7kgf/cm <sup>2</sup> (0.14~0.7MPa)	
Stroke	0~90°	
Impedance	Max 460 Ohm/20mA DC	
Air Connection	PT (NPT) 1/4	
Gauge Connection	PT (NPT) 1/8	
Conduit	PF 1/2 (G1/2)	
Repeatability	±0.3%F.S.	
Sensor Operating Temp.	-40~120 °C (-40~248 °F)	
Body Operating Temp.	-40~85 °C (-22~185 °F)	
Explosion Temp.	-40~60 °C (T5)/-40~40 °C (T6)	
Linearity	±0.5% F.S.	
Hysteresis	±0.5% F.S.	
Sensitivity	±0.2% F.S.	
Air Consumption	Below 2LPM(sup=1.4K)	
Flow Capacity	70LPM	
Output Characteristics	Linear, EQ%, Quick Open User set(16Point)	
Material	Aluminum Diecasting	
Protection	IP66	
Explosion Proof	ExiallCT6	
Weight	Body	1.5kg(3.3lb)
	Sensor	0.9kg(2.0lb)

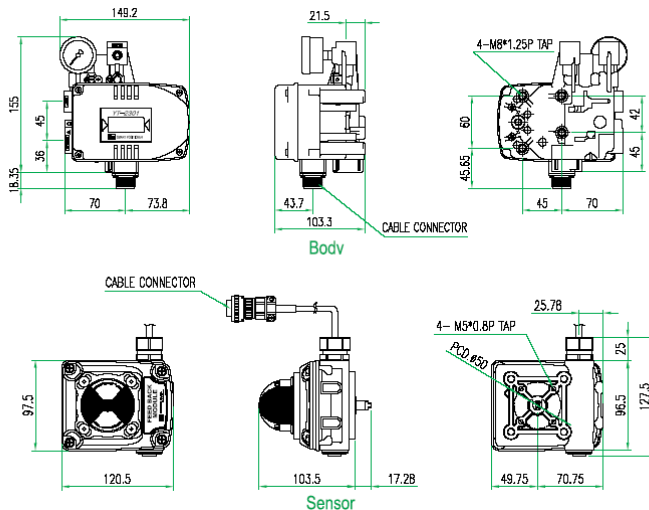

Smart positioner YT-2301R is supplying additional Remote Function into all the exist smart operation and have higher reliability and convenience in the circumstances of high temperature & vibrations by installed feedback sensors in Controlvalve and Positioners in requested places.

- Available Installation separately Feedback sensor parts from the Positioner body itself.
- LCD attached outside of the product makes to inspect the state of positioner in the field.
- All kinds of information for valve and positiner can be processed with using Hart communication.
- Valve system can be stable by outputting analog feedback signal.
- Various valve characteristics such as linear, quick open , equal percentage are available.
- PID parameters can be adjusted easily in the field only by button without communicator.

## Smart Positioner YT-2400 (Flameproof Type)

Ordering Symbols: YT-2400L / YT-2400R ■ ■ ■ ■ ■

Model	Acting Type	Explosion Proof	Lever Type		Connection Type	Communication	Option
YT-2400 L	<span style="border: 1px solid black; padding: 1px;">S</span> Single Acting	<span style="border: 1px solid black; padding: 1px;">H</span> ExdII BT6+H2	<span style="border: 1px solid black; padding: 1px;">1</span> 10~40mm	<span style="border: 1px solid black; padding: 1px;">1</span> M6×40L	<span style="border: 1px solid black; padding: 1px;">1</span> PT	<span style="border: 1px solid black; padding: 1px;">○</span> NONE	<span style="border: 1px solid black; padding: 1px;">○</span> NONE
YT-2400R	<span style="border: 1px solid black; padding: 1px;">D</span> Double Acting		<span style="border: 1px solid black; padding: 1px;">2</span> 20~70 mm	<span style="border: 1px solid black; padding: 1px;">2</span> M6×63L	<span style="border: 1px solid black; padding: 1px;">2</span> NPT	<span style="border: 1px solid black; padding: 1px;">■</span> HART	<span style="border: 1px solid black; padding: 1px;">1</span> + Transmitter
			<span style="border: 1px solid black; padding: 1px;">3</span> 50~100 mm	<span style="border: 1px solid black; padding: 1px;">3</span> M8×40L			
			<span style="border: 1px solid black; padding: 1px;">4</span> 100~150 mm	<span style="border: 1px solid black; padding: 1px;">4</span> M8×63L	<span style="border: 1px solid black; padding: 1px;">2</span> + Limit Switch		
				<span style="border: 1px solid black; padding: 1px;">5</span> NAMUR		<span style="border: 1px solid black; padding: 1px;">3</span> + Transmitter	
							With Limit Switch



YT-2400L



YT-2400R

### Specifications

Item.Type	Single	Double
Input Signal	4-20mA DC	
Supply Pressure	1.4~7kgf/cm <sup>2</sup> (0.14~0.7MPa)	
Stroke	10~150mm	0~90°
Impedance	Max.430 Ohm/20mA DC	
Air Connection	PT (NPT) 1/4	
Gauge Connection	PT (NPT) 1/8	
Conduit	PF 1/2 (G1/2)	
Repeatability	±0.3% F.S.	
Ambient Temp	Operating	-30~85 °C (-22~185°F)
	Explosion	-20~60 °C (-4~140°F)
Linearity	±0.5% F.S.	
Hysteresis	±0.5% F.S.	
Sensitivity	±0.2% F.S.	
Air Consumption	Below 2LPM(sup=1.4K)	
Flow Capacity	70LPM	
Output Characteristics	Linear, EQ%, Quick Open User set(16Point)	
Material	Aluminum Diecasting	
Protection	IP66	
Explosion Proof	ExdII BT6+H2	
Weight	3.35kg(7.37lb)	

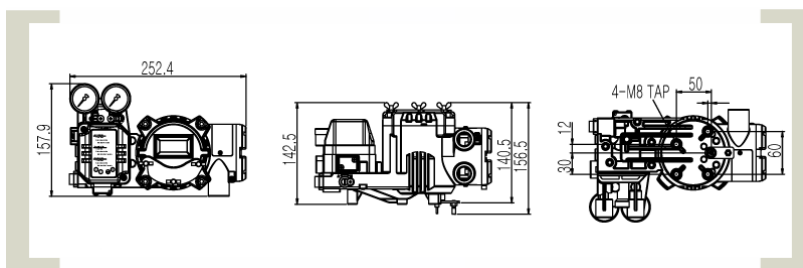

YT-2400 Smart Valve Positioner controls valve stroke accurately according to input signal of 4-20mA being input from controller. In addition, highly efficient microprocessing operator built in the product performs various and powerful functions like Auto calibration, PID control, Alarm and Hart protocol.

- LCD attached outside of the product makes to inspect the state of positioner in the field.
- All kinds of information for valve and positiner can be processed with using Hart communication.
- Valve system can be stable by outputting analog feedback signal.
- Various valve characteristics such as linear, quick open , equal percentage are available.
- PID parameters can be adjusted easily in the field only by button without communicator.
- It has the protection grade of IP 66.

## Electro-Pneumatic Positioner YT-1300 (Analog Type)

Ordering Symbols: YT-1300L / YT-1300R ■ ■ ■ ■ ■

Model	Acting Type	Explosion Proof	Lever Type		Connection Type	Option
YT-1300L	<span style="border: 1px solid black; padding: 0 2px;">S</span> Single Acting	<span style="border: 1px solid black; padding: 0 2px;">r</span> Non-Explosion	<span style="border: 1px solid black; padding: 0 2px;">1</span> 10~40mm	<span style="border: 1px solid black; padding: 0 2px;">1</span> M6×40L	<span style="border: 1px solid black; padding: 0 2px;">1</span> PT	<input type="checkbox"/> NONE
YT-1300R	<span style="border: 1px solid black; padding: 0 2px;">D</span> Double Acting	<span style="border: 1px solid black; padding: 0 2px;">E</span> ExialIBT6	<span style="border: 1px solid black; padding: 0 2px;">2</span> 20~70 mm	<span style="border: 1px solid black; padding: 0 2px;">2</span> M6×63L	<span style="border: 1px solid black; padding: 0 2px;">2</span> NPT	<span style="border: 1px solid black; padding: 0 2px;">1</span> + Transmitter
			<span style="border: 1px solid black; padding: 0 2px;">3</span> 50~100 mm	<span style="border: 1px solid black; padding: 0 2px;">3</span> M8×40L		
			<span style="border: 1px solid black; padding: 0 2px;">4</span> 100~150 mm	<span style="border: 1px solid black; padding: 0 2px;">4</span> M8×63L	<span style="border: 1px solid black; padding: 0 2px;">2</span> + Limit Switch	
			<span style="border: 1px solid black; padding: 0 2px;">5</span> NAMUR			<span style="border: 1px solid black; padding: 0 2px;">3</span> + Transmitter With Limit Switch



### Specifications

Item.Type	Single	Double
Input Signal	4-20mA DC	
Supply Pressure	1.4~7kgf/cm <sup>2</sup> (20~100psi)	
Stroke	10~150mm	0~90°
Impedance	Max.430 Ohm/20mA DC	
Air Connection	PT (NPT) 1/4	
Gauge Connection	PT (NPT) 1/8	
Conduit	PF 1/2 (G1/2)	
Repeatability	±0.3%F.S.	
Ambient Temp	Operating	-30~85 °C (-22~185°F)
	Explosion	-20~60 °C (-4~140°F)
Linearity	±0.5% F.S.	
Hysteresis	±0.5% F.S.	
Sensitivity	±0.2% F.S.	
Material	Aluminum Diecasting	
Protection	IP66	
Explosion Proof	ExialIBT6	
Weight	1.5kg(3.3lb)	

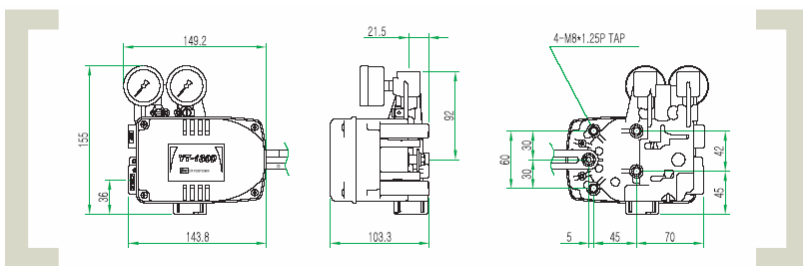

YT-1300 E/P Positioner controls valve stroke accurately by 4-20mA current signal being input from controller. It has built-in electronic circuit and P, D control circuit to prevent hunting. And Position transmitter and Limit switch are easily added optionally, which is time and cost-effective when it is applied in the field.

- It endures severe vibration and so it can be applied to almost every lines.
- Most suitable accuracy and dynamic characteristics are available by PD control.
- Valve system is stabilized by outputting analog feedback with option.
- The variable orifice makes to settle the problems easily which can be solved by attaching speed control valve.
- Limit switch is added with ease.

## Electro-Pneumatic Positioner YT-1350 (Stainless Steel Linear Type)

Ordering Symbols: YT-1350L / YT-1350R ■ ■ ■ ■ ■

Model	Acting Type	Explosion Proof	Lever Type		Connection Type	Option
YT-1350L	<span style="border: 1px solid black; padding: 2px;">S</span> Single Acting	<span style="border: 1px solid black; padding: 2px;">n</span> Non-Explosion	<span style="border: 1px solid black; padding: 2px;">1</span> 10~40mm	<span style="border: 1px solid black; padding: 2px;">1</span> M6×40L	<span style="border: 1px solid black; padding: 2px;">1</span> PT	<input type="checkbox"/> NONE
YT-1350R	<span style="border: 1px solid black; padding: 2px;">D</span> Double Acting	<span style="border: 1px solid black; padding: 2px;">ExialIBT6</span>	<span style="border: 1px solid black; padding: 2px;">2</span> 20~70 mm	<span style="border: 1px solid black; padding: 2px;">2</span> M6×63L	<span style="border: 1px solid black; padding: 2px;">2</span> NPT	<span style="border: 1px solid black; padding: 2px;">1</span> + Transmitter
			<span style="border: 1px solid black; padding: 2px;">3</span> 50~100 mm	<span style="border: 1px solid black; padding: 2px;">3</span> M8×40L		<span style="border: 1px solid black; padding: 2px;">2</span> + Limit Switch
			<span style="border: 1px solid black; padding: 2px;">4</span> 100~150 mm	<span style="border: 1px solid black; padding: 2px;">4</span> M8×63L	<span style="border: 1px solid black; padding: 2px;">3</span> + Transmitter With Limit Switch	
				<span style="border: 1px solid black; padding: 2px;">5</span> NAMUR		



### Specifications

Item.Type	YT-1350L	YT-1350R
Input Signal	4-20mA DC	
Supply Pressure	1.4~7kgf/cm <sup>2</sup> (20~100psi)	
Stroke	10~150mm	0~90°
Impedance	Max.430 Ohm/20mA DC	
Air Connection	PT (NPT) 1/4	
Gauge Connection	PT (NPT) 1/8	
Conduit	PF 1/2 (G1/2)	
Repeatability	±0.3%F.S.	
Ambient Temp	Operating	-30~85 °C (-22~185°F)
	Explosion	-20~60 °C (-4~140°F)
Linearity	±0.5% F.S.	
Hysteresis	±0.5% F.S.	
Sensitivity	±0.2% F.S.	
Material	Stainless Steel 316	
Protection	IP66	
Explosion Proof	ExialIBT6	
Weight	3.7kg(8.16lb)	

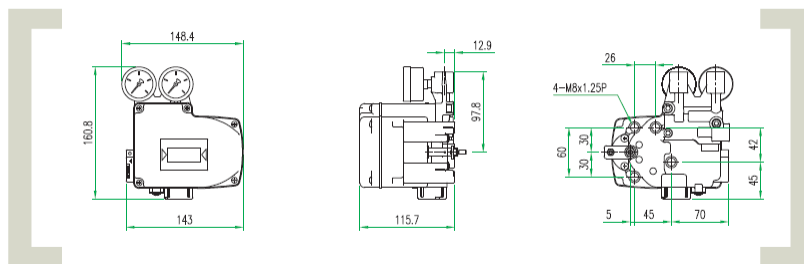

YT-1350 E/P Positioner controls valve stroke accurately by 4-20mA current signal being input from controller. It has built-in electronic circuit and P, D control circuit to prevent hunting. And Position transmitter and Limit switch are easily added optionally, which is time and cost-effective when it is applied in the field.

- It endures severe vibration and so it can be applied to almost every lines.
- Most suitable accuracy and dynamic characteristics are available by PD control.
- Valve system is stabilized by outputting analog feedback with option.
- The variable orifice makes to settle the problems easily which can be solved by attaching speed control valve.
- Limit switch is added with ease.

## Electro-Pneumatic Positioner YT-1000L (Linear Type)

Ordering Symbols: YT-1000L

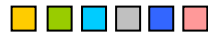

Model	Acting Type	Explosion Proof	Lever Type	Orifice Type	Connection Type	Ambient Temp
YT-1000 L	Single Acting	ExdmIIBT5	10~40 mm	Φ1	PT	-20℃~60℃
	Double Acting	ExdmIICT5	30~70 mm	Φ2	NPT	-20℃~120℃
		ExialIBT6	60~100 mm	None		-40℃~70℃
		Non-Explosion	100~150 mm			



### Specifications

Item.Type	Single	Double
Input Signal	4-20mA DC	
Impedance	250±15 Ohm	
Supply Pressure	1.4~7kgf/cm <sup>2</sup> (20~100psi)	
Stroke	10~150mm	
Air Connection	PT (NPT) 1/4	
Gauge Connection	PT (NPT) 1/8	
Conduit	PF 1/2 (G1/2)	
Explosion Proof	Ex dm IIB T5 Ex dm IIC T5 Ex ia IIB T6	
Protection	IP66	
Ambient Temp	-20℃~70℃ (Operating Temp.) -20℃~60℃ (Explosion Temp.)	
Linearity	±1% F.S.	±2% F.S.
Hysteresis	±1% F.S.	
Sensitivity	±0.2% F.S.	±0.5% F.S.
Repeatability	±0.5% F.S.	
Air Consumption	3LPM (Sup=1.4kgf/cm <sup>2</sup> , 20psi)	
Flow Capacity	80LPM (Sup=1.4kgf/cm <sup>2</sup> , 20psi)	
Material	Aluminum Diecasting	
Weight	2.7kg(6.1lb)	

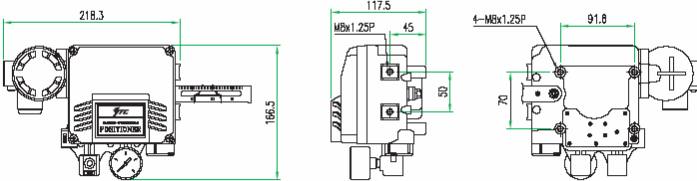

The Electro-Pneumatic Positioner YT-1000L is used for operation of pneumatic linear valve actuators by means of electrical controller or control system with an analog output signal of DC 4 to 20 mA or split Ranges.

- There is no resonance at 5~200Hz.
- The change of RA/DA Action is convenient, it is able to apply to single or double acting actuator.
- It is possible to prevent the hunting with orifice to the small size actuator.
- It is economical due to less air consumption.
- It is able to control the 1/2 split range with simple operation without replacement of parts.

## Electro-Pneumatic Positioner YT-1000R (Rotary Type)

Ordering Symbols: YT-1000R



Model	Acting Type	Explosion Proof	Lever Type	Orifice Type	Connection Type	Ambient Temp	Option1	Option2
YT-1000R	<b>S</b> Single Acting	<b>m</b> Exd mIIBT5	<b>1</b> M6×40L	<b>1</b> φ1	<b>1</b> PT	<b>S</b> -20℃~60℃	<b>0</b> NONE(St'd)	<b>0</b> NONE
	<b>D</b> Double Acting	<b>g</b> ExdmIIC T5	<b>2</b> M6×63L	<b>2</b> φ2	<b>2</b> NPT	<b>H</b> -20℃~120℃	<b>1</b> Dome Cover	<b>1</b> +PTM(Internal)
		<b>l</b> ExialIIB T6	<b>3</b> M8×40L	<b>3</b> NONE		<b>L</b> -40℃~70℃		<b>2</b> +PTM(External)
		<b>n</b> Non-Explosion	<b>4</b> M8×63L					<b>3</b> +L/S(Internal)
			<b>5</b> NAMUR				<b>4</b> +L/S(External)	
								<b>5</b> +PTM+L/S(Internal)



### Specifications

Item.Type	Single	Double
Input Signal	4-20mA DC	
Impedance	250±15 Ohm	
Supply Pressure	1.4~7kgf/cm <sup>2</sup> (20~100psi)	
Stroke	0~90°	
Air Connection	PT (NPT) 1/4	
Gauge Connection	PT (NPT) 1/8	
Conduit	PF 1/2 (G1/2)	
Explosion Proof	Ex dm IIB T5 Ex dm IIC T5 Ex ia IIB T6	
Protection	IP66	
Ambient Temp	-20℃~70℃ (Operating Temp.) -20℃~60℃ (Explosion Temp.)	
Linearity	±1% F.S.	±2% F.S.
Hysteresis	±1% F.S.	
Sensitivity	±0.2% F.S.	±0.5% F.S.
Repeatability	±0.5% F.S.	
Air Consumption	3LPM(Sup=1.4kgf/cm <sup>2</sup> , 20psi)	
Flow Capacity	80LPM(Sup=1.4kgf/cm <sup>2</sup> , 20psi)	
Material	Aluminum Diecasting	
Weight	2.8kg(6.2lb)	

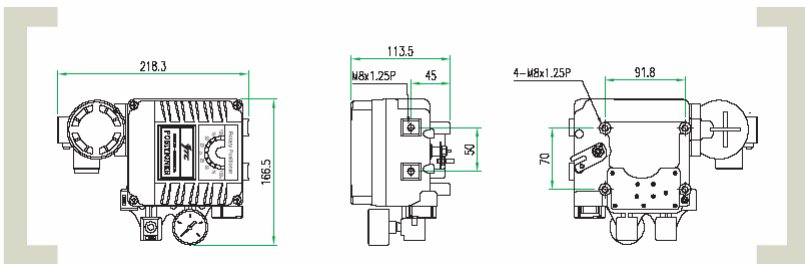

The Electro-Pneumatic Positioner YT-1000R is used for operation of pneumatic rotary valve actuators by means of electrical controller or control systems with an analog output signal of DC 4 to 20mA or split ranges.

- There is no resonance at 5~200Hz.
- The change of RA/DA Acting is convenient, it is able to apply to single or double acting actuator.
- It is possible to prevent the hunting with orifice to the small size actuator.
- It is economical due to less air consumption.
- It is able to control the 1/2 split range with simple operation without replacement of parts.

## Electro-Pneumatic Positioner YT-1000R (Dome Cover)

Ordering Symbols: YT-1000R



Model	Acting Type	Explosion Proof	Lever Type	Orifice Type	Connection Type	Ambient Temp	Option1	Option2
YT-1000R	<b>S</b> Single Acting	<b>m</b> Exd mIIBT5	<b>1</b> M6×40L	<b>1</b> φ1	<b>1</b> PT	<b>S</b> -20℃~60℃	<b>0</b> NONE(St'd)	<b>0</b> NONE
	<b>D</b> Double Acting	<b>g</b> ExdmIIC T5	<b>2</b> M6×63L	<b>2</b> φ2	<b>2</b> NPT	<b>H</b> -20℃~120℃	<b>1</b> Dome Cover	<b>1</b> +PTM(Internal)
		<b>l</b> ExialIBT6	<b>3</b> M8×40L	<b>3</b> NONE		<b>L</b> -40℃~70℃		<b>2</b> +PTM(External)
		<b>n</b> Non-Explosion	<b>4</b> M8×63L	<b>5</b> NAMUR				<b>3</b> +L/S(Internal)
								<b>4</b> +L/S(External)
								<b>5</b> +PTM+L/S(Internal)



### Specifications

Item.Type	Single	Double
Input Signal	4-20mA DC	
Impedance	250±15 Ohm	
Supply Pressure	1.4~7kgf/cm <sup>2</sup> (20~100psi)	
Stroke	0~90°	
Air Connection	PT (NPT) 1/4	
Gauge Connection	PT (NPT) 1/8	
Conduit	PF 1/2 (G1/2)	
Explosion Proof	Ex dm IIB T5 Ex dm IIC T5 Ex ia IIB T6	
Protection	IP66	
Ambient Temp	-20℃~70℃ (Operating Temp.) -20℃~60℃ (Explosion Temp.)	
Linearity	±1% F.S.	±2% F.S.
Hysteresis	±1% F.S.	
Sensitivity	±0.2% F.S.	±0.5% F.S.
Repeatability	±0.5% F.S.	
Air Consumption	3LPM(Sup=1.4kgf/cm <sup>2</sup> ,20psi)	
Flow Capacity	80LPM(Sup=1.4kgf/cm <sup>2</sup> ,20psi)	
Material	Aluminum Diecasting	
Weight	2.8kg(6.2lb)	

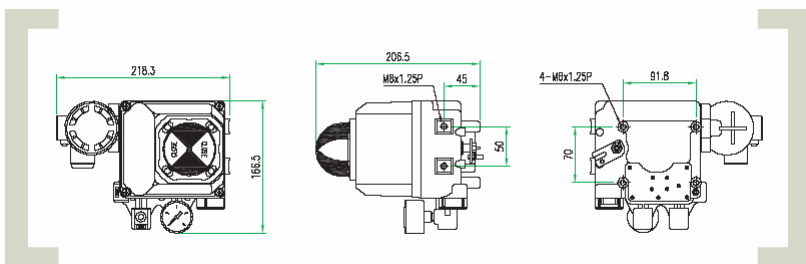

The Electro-Pneumatic Positioner YT-1000R is used for operation of pneumatic rotary valve actuators by means of electrical controller or control systems with an analog output signal of DC 4 to 20 mA or split ranges and Dome Indicator is attached.

- The confirmation of positioner's operating angle is possible by watching in the long distance due to Dome Indicator.
- The change of RA/DA Action is convenient, it is able to apply to single or double acting actuator.
- It is possible to prevent the hunting with orifice to the small actuator.
- It is economical due to less air consumption.
- It is able to control the 1/2 split range with simple operation without replacement of parts.

## Electro-Pneumatic Positioner YT-1000R with PTM (Internal)

Ordering Symbols: YT-1000R



Model	Acting Type	Explosion Proof	Lever Type	Orifice Type	Connection Type	Ambient Temp	Option1	Option2
YT-1000R	<b>S</b> Single Acting	<b>m</b> Exd mIBT5	<b>1</b> M6×40L	<b>1</b> φ1	<b>1</b> PT	<b>S</b> -20℃~60℃	<b>0</b> St'd Indicator	<b>0</b> NONE
	<b>D</b> Double Acting	<b>g</b> Exd mICT5	<b>2</b> M6×63L	<b>2</b> φ2	<b>2</b> NPT	<b>H</b> -20℃~120℃	<b>1</b> Dome Indicator	<b>1</b> +PTM(Internal)
		<b>l</b> ExiallBT6	<b>3</b> M8×40L	<b>3</b> NONE		<b>L</b> -40℃~70℃		<b>2</b> +PTM(External)
		<b>n</b> Non-Explosion	<b>4</b> M8×63L					<b>3</b> +L/S(Internal)
			<b>5</b> NAMUR				<b>4</b> +L/S(External)	
								<b>5</b> +PTM+L/S(Internal)



### Specifications

PTM	Input Type	2Wire
	Input Signal	90°
	Output Signal	4-20mA DC
	Load Resistance	Max.880Ω/30VDC
	Noise Range	50mVp.p
	Adjustable Range	Zero : ±10% Span : 60~110%
	Protection	IP66
	Linearity	±1%
	Sensitivity	±0.2%
	Hysteresis	±0.2%
	Supply Voltage	9~30V DC
	Explosion Proof	Non-Explosion
Positioner	Same with YT-1000R (Page14)	

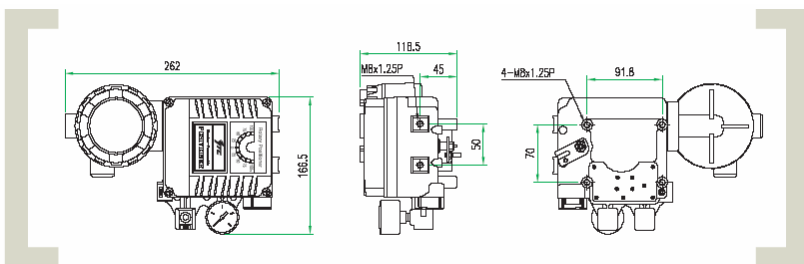

The Electro-Pneumatic Positioner YT-1000R is used for operation of pneumatic rotary valve actuators by means of electrical controller or control systems with an analog output signal of DC 4 to 20mA or split ranges. And position transmitter which is built internally outputs present opening rate with changing this to current signal of DC 4~20mA.

- Stability of the system is improved by output current signal of positioner.
- It isn't necessary any other extra bracket for position transmitter.
- The change of RA/DA Action is convenient, it is able to apply to single or double acting actuator.
- It is possible to prevent the hunting with orifice to the small size actuator.
- It is economical due to less consumption.



## Electro-Pneumatic Positioner YT-1000R with PTM (External)

Ordering Symbols: YT-1000R



Model	Acting Type	Explosion Proof	Lever Type	Orifice Type	Connection Type	Ambient Temp	Option1	Option2
YT-1000R	<b>S</b> Single Acting	<b>m</b> Exd mIBT5	<b>1</b> M6×40L	<b>1</b> φ1	<b>1</b> PT	<b>S</b> -20℃~60℃	<b>0</b> St'd Indicator	<b>0</b> NONE
	<b>D</b> Double Acting	<b>g</b> Exd mICT5	<b>2</b> M6×63L	<b>2</b> φ2	<b>2</b> NPT	<b>H</b> -20℃~120℃	<b>1</b> Dome Indicator	<b>1</b> +PTM(Internal)
		<b>l</b> ExialIBT6	<b>3</b> M8×40L	<b>3</b> NONE		<b>L</b> -40℃~70℃	<b>2</b> +PTM(External)	
		<b>n</b> Non-Explosion	<b>4</b> M8×63L	<b>4</b> NONE		<b>3</b> +L/S(Internal)		
			<b>5</b> NAMUR			<b>4</b> +L/S(External)	<b>5</b> +PTM+L/S(Internal)	



### Specifications

PTM	Input Type	2Wire
	Input Signal	90°
	Output Signal	4-20mA DC
	Load Resistance	Max.880Ω/30VDC
	Noise Range	50mVp.p
	Adjustable Range	Zero : ±10% Span : 60~110%
	Explosion Proof	Exd II CT6
	Protection	IP66
	Linearity	±1%
	Sensitivity	±0.2%
	Hysteresis	±0.2%
	Supply Voltage	9~30V DC
Positioner	Same with YT-1000R (Page14)	

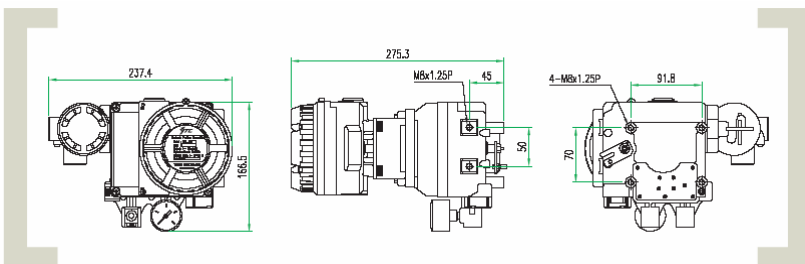

The Electro-Pneumatic Positioner YT-1000R is used for operation of pneumatic rotary valve actuators by means of electrical controller or control systems with an analog output signal of DC 4 to 20mA or split ranges. And Positon Transmitter which is built internally outputs present opening rate with changing this to current signal of DC 4~20mA maintaining explosion proof type.

- Stability of system is improved by the position transmitter which outputs current signal of positoner's operating and feedback to controller.
- It isn't necessary extra bracket for positon transmitter, and it is ablt to manage positioner and transmitter repectively.
- It is able to use in the environment with explosive gas due to explosion-proof structure.
- The change of RA/DA Action is convenient, it is able to apply to single or double acting actuator.
- It is possible to prevent the hunting with orifice to the small size actuator.

## Electro-Pneumatic Positioner YT-1000R with L/S (Internal)

Ordering Symbols: YT-1000R

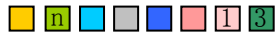

Model	Acting Type	Explosion Proof	Lever Type	Orifice Type	Connection Type	Ambient Temp	Option1	Option2
YT-1000R	<b>S</b> Single Acting	<b>m</b> Exd mIBT5	<b>1</b> M6×40L	<b>1</b> φ1	<b>1</b> PT	<b>S</b> -20℃~60℃	<b>0</b> St'd Indicator	<b>0</b> NONE
	<b>D</b> Double Acting	<b>n</b> ExdmlICT5	<b>2</b> M6×63L	<b>2</b> φ2	<b>2</b> NPT	<b>H</b> -20℃~120℃	<b>1</b> Dome Indicator	<b>1</b> +PTM(Internal)
		<b>l</b> ExiallBT6	<b>3</b> M8×40L	<b>3</b> NONE		<b>L</b> -40℃~70℃		<b>2</b> +PTM(External)
		<b>r</b> Non-Explosion	<b>4</b> M8×63L	<b>5</b> NAMUR				<b>3</b> +L/S(Internal)
								<b>4</b> +L/S(External)
								<b>5</b> +PTM+L/S(Internal)

### Specifications

Limit	Rating	AC 0.6A 125V~16A
Switch	Switch Type	2 x SPDT
Positioner	Same with YT-1000R (Page14)	

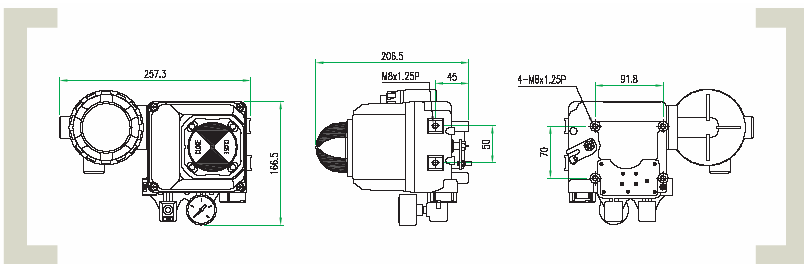

The Electro-Pneumatic Positioner YT-1000R is used for operation of pneumatic rotary valve actuators by means of electrical controller or control systems with an analog output signal of DC 4 to 20mA or split ranges and Limit Switch is attached internally.

- It is able to get feedback of electrical signal in setting particular opening point due to built in Limit Switch.
- It isn't necessary extra bracket for Limit Switch, and it is convenient to install and maintain.
- The confirmation of positioner's opening rate is possible in the long distance due to Dome Indicator.
- The change of RA/DA Action is convenient, it is able to apply to single or double acting actuator.
- It is possible to prevent the hunting with orifice to the small size actuator.

## Electro-Pneumatic Positioner YT-1000R with L/S (External)

Ordering Symbols: YT-1000R



Model	Acting Type	Explosion Proof	Lever Type	Orifice Type	Connection Type	Ambient Temp	Option1	Option2
YT-1000R	Single Acting	Exd mIBT5	M6×40L	φ1	PT	-20℃~60℃	St'd Indicator	NONE
	Double Acting	Exd mICT5	M6×63L	φ2	NPT	-20℃~120℃	Dome Indicator	+PTM(Internal)
		ExiallBT6	M8×40L	NONE	-40℃~70℃	+PTM(External)		
		Non-Explosion	M8×63L	+L/S(Internal)				
			NAMUR	+L/S(External)				
		+PTM+L/S(Internal)						

### Specifications

Limit	Rating	AC 0.6A 125V~16A
Switch	Switch Type	2 x SPDT
Positioner	Same with YT-1000R (Page14)	

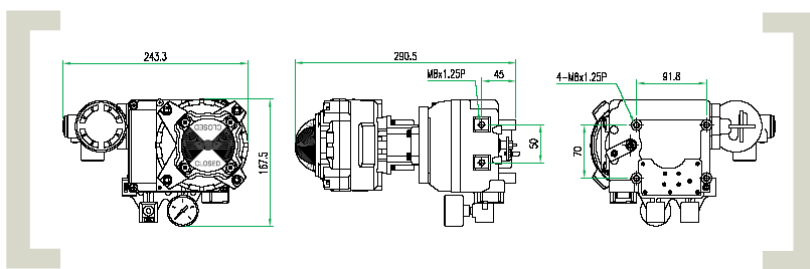

The Electro-Pneumatic Positioner YT-1000R is used for operation of pneumatic rotary valve actuators by means of electrical controller or control systems with an analog output signal of DC 4 to 20mA or split ranges and Limit switch is attached externally.

- It is able to manage Positioner and Limit switch respectively.
- It isn't necessary extra bracket for Limit switch.
- The change of RA/DA Action is convenient, it is able to apply to single or double acting and actuator.
- It is possible to prevent the hunting with orifice to the small size actuator.
- It is economical due to less air consumption.

## Electro-Pneumatic Positioner YT-1000R with PTM & L/S (Internal)

Ordering Symbols: YT-1000R



Model	Acting Type	Explosion Proof	Lever Type	Orifice Type	Connection Type	Ambient Temp	Option1	Option2
YT-1000R	<b>S</b> Single Acting	<b>m</b> Exd mIBT5	<b>1</b> M6×40L	<b>1</b> Φ1	<b>1</b> PT	<b>S</b> -20℃~60℃	<b>0</b> NONE(St'd)	<b>0</b> NONE
	<b>D</b> Double Acting	<b>E</b> ExdmIIC5	<b>2</b> M6×63L	<b>2</b> φ2	<b>2</b> NPT	<b>H</b> -20℃~120℃	<b>1</b> Dome Cover	<b>1</b> +PTM(Internal)
		<b>E</b> ExialIBT6	<b>3</b> M8×40L	<b>3</b> NONE		<b>L</b> -40℃~70℃		<b>2</b> +PTM(External)
		<b>n</b> Non-Explosion	<b>4</b> M8×63L					<b>3</b> +L/S(Internal)
			<b>5</b> NAMUR				<b>4</b> +L/S(External)	
								<b>5</b> +PTM+L/S(Internal)



### Specifications

PTM	Input Type	2Wire
	Input Signal	0~90°
	Output Signal	4-20mA DC
	Load Resistance	Max.880Ω/ 30VDC
	Noise Range	50mVp.p
	Adjustable Range	Zero : ±10% Span : ±60~110%
	Protection	IP66
	Linearity	±1%
	Sensitivity	±0.2%
	Hysteresis	±0.2%
	Supply Voltage	9~30V DC
Limit	Rating	AC 0.6A 125V~16A 250V
Switch	Switch type	2x SPDT
Positioner	Same with YT-1000R (Page14)	

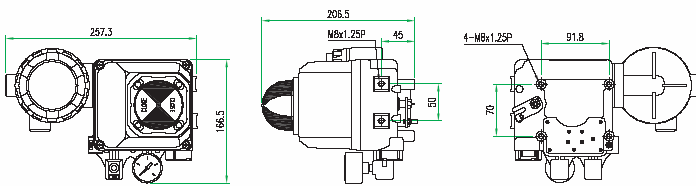

The Electro-Pneumatic Positioner YT-1000R is used for operation of pneumatic rotary valve actuators by means of electrical controller or control systems with an analog output signal of DC 4 to 20mA or split ranges and Position transmitter & Limit switch is attached internally.

- Stability of system is improved by built in Position transmitter and Limit switch.
- It isn't necessary extra bracket for Position transmitter or Limit switch.
- The confirmation of positioner's operating angle is possible by watching in the long-distance due to Dome indicator.
- The change of RA/DA Action is convenient, it is able to apply to single or double acting and actuator.
- It is possible to prevent the hunting with orifice to the small size actuator.

## Electro-Pneumatic Positioner YT-1000R with PTM & L/S (External)

Ordering Symbols: YT-1000R

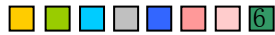

Model	Acting Type	Explosion Proof	Lever Type	Orifice Type	Connection Type	Ambient Temp	Option1	Option2
YT-1000R	<b>S</b> Single Acting	<b>m</b> Exd mIBT5	<b>1</b> M6×40L	<b>1</b> Φ1	<b>1</b> PT	<b>S</b> -20℃~60℃	<b>0</b> St'd Indicator	<b>0</b> NONE
	<b>D</b> Double Acting	<b>c</b> Exd mICT5	<b>2</b> M6×63L	<b>2</b> φ2	<b>2</b> NPT	<b>H</b> -20℃~120℃	<b>1</b> Dome Indicator	<b>1</b> +PTM(Internal)
		<b>l</b> ExialIBT6	<b>3</b> M8×40L	<b>3</b> NONE		<b>L</b> -40℃~70℃		<b>2</b> +PTM(External)
		<b>n</b> Non-Explosion	<b>4</b> M8×63L					<b>3</b> +L/S(Internal)
			<b>5</b> NAMUR				<b>4</b> +L/S(External)	
								<b>5</b> +PTM+L/S(Internal)
								<b>6</b> +PTM+L/S(External)



### Specifications

PTM	Item.Type	PTM 6R
	Input Type	2Wire
	Input Signal	0~90°
	Output Signal	4-20mA DC
	Load Resistance	Max.880Ω/30VDC
	Supply Voltage	9~30V DC
	Noise Range	50mVp.p
	Conduit	PF1/2(G1/2)
	Explosion Proof	ExdIICT6
	Ambient Temp	-20℃~70℃ (Operating) -20℃~60℃ (Explosion)
	Linearity	±1%F.S.
	Sensitivity	±0.2% F.S.
	Hysteresis	±0.2% F.S.
	Material	Aluminum
Limit	Rating	0.6A 125V~16A 250V AC
Switch	Switch Type	2x SPDT
Positioner	Same with YT-1000R (Page14)	

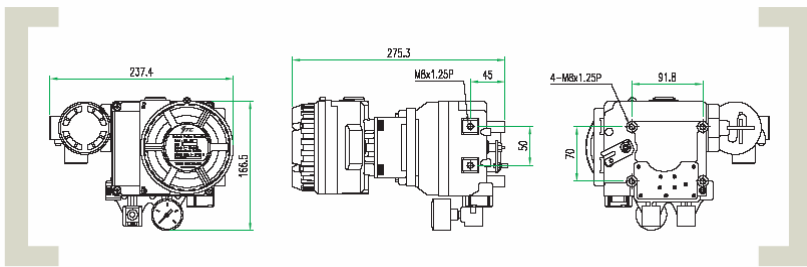

The Electro-Pneumatic positioner YT-1000R is used for operation of pneumatic rotary valve actuators by means of electrical controller or control systems with an analog output signal of DC 4 to 20mA or split ranges and Position transmitter & Limit switch is attached externally.

- Stability of system is improved by built in Position transmitter and Limit switch.
- It is not necessary extra bracket of Position transmitter or Limit switch.
- The change of RA/DA Action is convenient, it is able to apply to single or double acting and actuator.
- It is possible to prevent the hunting with orifice to the small size actuator.

## Pneumatic- Pneumatic Positioner YT-1200L (Linear Type)

Ordering Symbols: YT-1200L

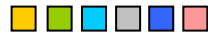

Model	Acting Type	Lever Type	Orifice Type	Connection Type	Ambient Temp
YT-1200L	Single Acting	10~40 mm	$\Phi 1$	PT	-20℃~70℃
	Double Acting	30~70 mm	$\Phi 2$	NPT	-20℃~120℃
		60~100 mm	NONE		-40℃~70℃
		100~150 mm			



### Specifications

Item.Type	Single	Double
Input Signal	0.2~1kgf/cm <sup>2</sup> (3~15psi)	
Supply Pressure	1.4~7kgf/cm <sup>2</sup> (20~100psi)	
Stroke	10~150mm	
Air Connection	PT (NPT) 1/4	
Gauge Connection	PT (NPT) 1/8	
Protection	IP66	
Ambient Temp	-20~70℃ (-4~158°F)	
Linearity	±1% F.S.	±2% F.S.
Hysteresis	±1% F.S.	
Sensitivity	±0.2% F.S.	±0.5% F.S.
Repeatability	±0.5% F.S.	
Air Consumption	3LPM (Sup=1.4kgf/cm <sup>2</sup> , 20psi)	
Flow Capacity	80LPM (Sup=1.4kgf/cm <sup>2</sup> , 20psi)	
Material	Aluminum Diecasting	
Weight	1.7kg(3.1lb)	

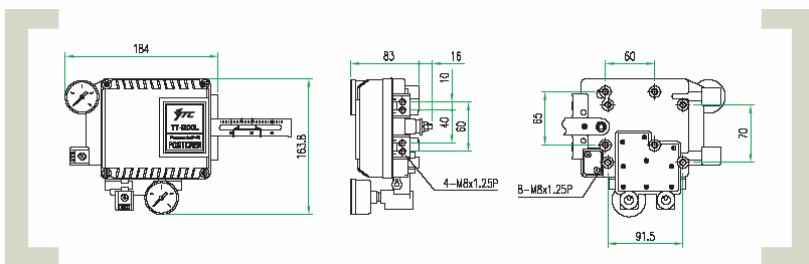

The Pneumatic positioner YT-1200L is used for pneumatic linear valve actuators by means of pneumatic controller or control systems with an output signal of 3 to 5psi or split ranges.

- Size is compact.
- The change of RA/DA Action is convenient, it is able to apply to single or double acting actuator.
- It is possible to prevent the hunting with orifice to the small size actuator.
- It is economical due to less air consumption.
- It is able to control the 1/2 split range with simple operation without replacement of parts.

## Pneumatic- Pneumatic Positioner YT-1200R (Rotary Type)

Ordering Symbols: YT-1200R



Model	Acting Type	Lever Type	Orifice Type	Connection Type	Ambient Temp
YT-1200R	Single Acting	M6×40L	φ1	PT	-20℃~70℃
	Double Acting	M6×63L	φ2	NPT	-20℃~120℃
		M8×40L	NONE		-40℃~70℃
		M8×63L			
		NAMUR			



### Specifications

Item.Type	Single	Double
Input Signal	0.2~1kgf/cm <sup>2</sup> (3~15psi)	
Supply Pressure	1.4~7kgf/cm <sup>2</sup> (20~100psi)	
Stroke	0~90°	
Air Connection	PT (NPT) 1/4	
Gauge Connection	PT (NPT) 1/8	
Protection	IP66	
Ambient Temp	-20~70℃ (-4~158°F)	
Linearity	±2% F.S.	
Hysteresis	±1% F.S.	
Sensitivity	±0.5% F.S.	
Repeatability	±0.5% F.S.	
Air Consumption	3LPM(Sup=1.4kgf/cm <sup>2</sup> , 20psi)	
Flow Capacity	80LPM(Sup=1.4kgf/cm <sup>2</sup> , 20psi)	
Material	Aluminum Diecasting	
Weight	1.7kg(3.1lb)	

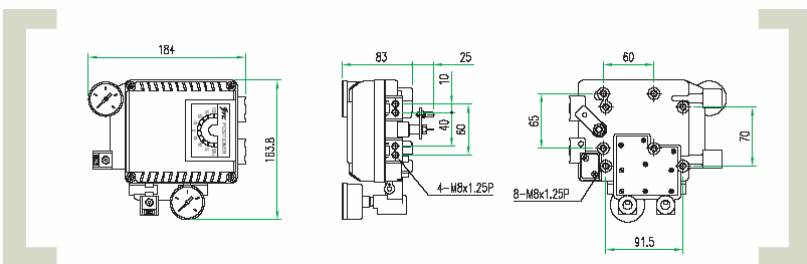

The Pneumatic positioner YT-1200R is used for pneumatic Rotary valve actuators by means of pneumatic controller or control systems with an output signal of 3 to 5psi or split ranges.

- Size is compact.
- The change of RA/DA Action is convenient, it is able to apply to single or double acting actuator.
- It is possible to prevent the hunting with orifice to the small size actuator.
- It is economical due to less air consumption.
- It is able to control the 1/2 split range with simple operation without replacement of parts.

## Air Filter Regulator YT-200, YT-205

Ordering Symbols: YT-200 / YT-205 ■ ■ ■ ■

Model	Adjustable Range	Connection Type	Gauge	Ambient Temp
YT-200	<span style="border: 1px solid black; padding: 2px;">A</span> 0~4.2kgf/cm <sup>2</sup>	<span style="border: 1px solid black; padding: 2px;">P</span> PT1/4	<span style="border: 1px solid black; padding: 2px;">O</span> NONE	<span style="border: 1px solid black; padding: 2px;">1</span> -20~70 °C
YT-205	<span style="border: 1px solid black; padding: 2px;">B</span> 0~8.4kgf/cm <sup>2</sup> <span style="border: 1px solid black; padding: 2px;">C</span> 0~2.1kgf/cm <sup>2</sup>	<span style="border: 1px solid black; padding: 2px;">N</span> NPT1/4	<span style="border: 1px solid black; padding: 2px;">1</span> 4Kgf/cm <sup>2</sup> <span style="border: 1px solid black; padding: 2px;">2</span> 10Kgf/cm <sup>2</sup>	<span style="border: 1px solid black; padding: 2px;">2</span> -20~120 °C



YT-200



YT-205

### Specifications

Item.Type	YT-200		YT-205
	A	B	C
Max.Supply Pressure	15kgf/cm <sup>2</sup> (231psi)		
Max.Output Pressure	4.2kgf/cm <sup>2</sup> (57psi)	8.4kgf/cm <sup>2</sup> (120psi)	2.1kgf/cm <sup>2</sup>
Air Connection	PT(NPT)1/4		
Gauge Connection	PT(NPT)1/4		
Ambient Temp	-20~70 °C (-4~158°F)		
Min.Filtering Size	5micron		
Material	Aluminum Diecasting		Stainless Steel 316
Weight	0.6kg(1.7lb)		1.4kg(3.0lb)

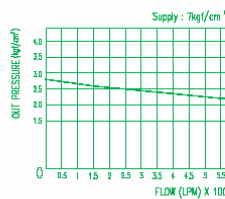
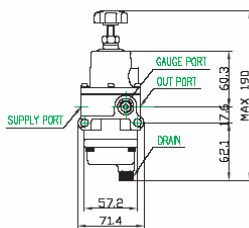

Air filter regulator YT-200, YT-205 reduces the supply pressure of plant's main air line suitably and supplies valve positioner or control device.

- maintains the stable outlet pressure regardless of the fluctuation of inputting pressure or flow rate.
- It is easy to install and maintain due to light weight and small size.
- To filter minuteness particle is available with 5 micron filter.
- There is relief function which discharges to atmosphere if the outlet pressure is higher than setting pressure.
- YT-205 has relief function which discharges to atmosphere if the outlet pressure is higher than setting pressure.



## Volume Booster YT-300 / YT-310 / 305 / 315

Ordering Symbols: YT-300 / YT-310 / YT-305 / YT-315 ■ ■

Model	Connection Type	Ambient Temp
YT-300	<span style="border: 1px solid purple; padding: 0 2px;">P</span> PT	<span style="border: 1px solid blue; padding: 0 2px;">1</span> -20~70 °C
YT-310	<span style="border: 1px solid blue; padding: 0 2px;">N</span> NPT	<span style="border: 1px solid blue; padding: 0 2px;">2</span> -20~120 °C
YT-305		
YT-315		



YT-300



YT-310

### Specifications

Item.Type	YT-300, YT-305	YT-310, YT-315	
Max. Supply Pressure	10kgf/cm <sup>2</sup> (142psi)		
Max. Output Pressure	7kgf/cm <sup>2</sup> (100psi)	10kgf/cm <sup>2</sup> (142psi)	
In / Output Pressure Ratio	1:1		
Flow Capacity(Cv)	1.02	4.98	
In / Output Connection	PT(NPT)1/4	NPT 3/4	
Signal Connection	PT(NPT)1/4		
Port Size	1/4"	1/2"	
Linearity	±1%(F.S.)		
Ambient Temp	-20~70 °C (-4~158°F)		
Material	YT-300, YT310	Aluminum Diecasting	
	YT-305, YT-315	Stainless Steel 316	
Weight	YT-300	YT-310	0.5kg(1.1 lb)
	YT-305	YT-315	5kg(11lb)

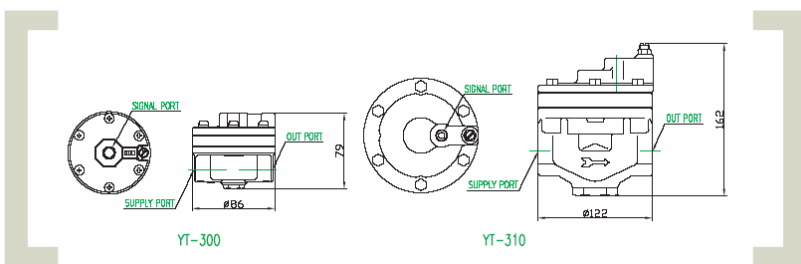

YT-305



YT-315

Volume booster YT-300 and YT-310 makes the valve function's speed fast with providing large air flow rate to actuator.

- Speed and accuracy is excellent with supplying air pressure at the rate of 1:1 steadily.
- It makes to improve the stability with control of By-Pass.
- It is an acute reflection of the change of signal pressure.
- It has a fixed deadband because this is controlled by the seat-to-seat dimension of the supply and exhaust plugs.

## Lock up Valve YT-400

Ordering Symbols: YT-400

Model	Acting Type	Connection Type
YT-400	<span style="border: 1px solid black; padding: 2px;">S</span> Single Acting	<span style="border: 1px solid black; padding: 2px;">PT1/4</span>
	<span style="border: 1px solid black; padding: 2px;">D</span> Double Acting	<span style="border: 1px solid black; padding: 2px;">NPT1/4</span>



### Specifications

Item.Type	Single	Double
Signal Pressure	Max.10kgf / cm <sup>2</sup> (142psi)	
Pressure Range	1.4~7kgf/cm <sup>2</sup> (20~100psi)	
Lock-up Pressure	Max.7kgf / cm <sup>2</sup> (100psi)	
Differential Pressure	Below 0.1kgf/cm <sup>2</sup> (1.4psi)	
Flow Capacity(Cv)	0.9	
Ambient Temp	-20~70 °C (-4~158°F)	
Air Connection	PT(NPT) 1/4	
Material	Aluminum Diecasting	
Weight	0.45kg(0.33lb)	0.7kg(1.5lb)

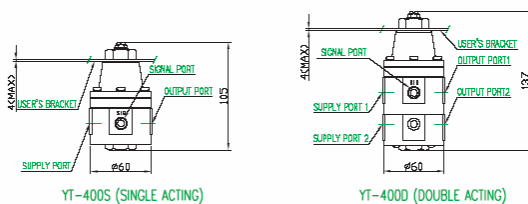

Lock up valve YT-400 closes the passage of air flow piping with sensing the pressure of main supply pressure when the pressure is lower than the setting pressure due to accident and so forth.

- It is able to install with metal piping without extra bracket due to small size and light weight.
- YT-400 reacts susceptibly at the minute differential pressure below 0.1kgf/cm<sup>2</sup>.
- Corrosion resistance is excellent with epoxy powder coating.
- For special type, it is able to attach Limit switch or Indicator which makes to catch whether YT-400 is opened or shut.

## Snap Acting Relay YT-500 / YT-510 / YT505 / YT-515

Ordering Symbols: YT-500 / YT-510 / YT-505 / YT-515

Model	Acting Type	Connection Type
YT-500	<span style="border: 1px solid black; padding: 2px;">S</span> Single	<span style="border: 1px solid black; padding: 2px;">1</span> PT
YT-510	<span style="border: 1px solid black; padding: 2px;">D</span> Double	<span style="border: 1px solid black; padding: 2px;">2</span> NPT
YT-505		
YT-515		

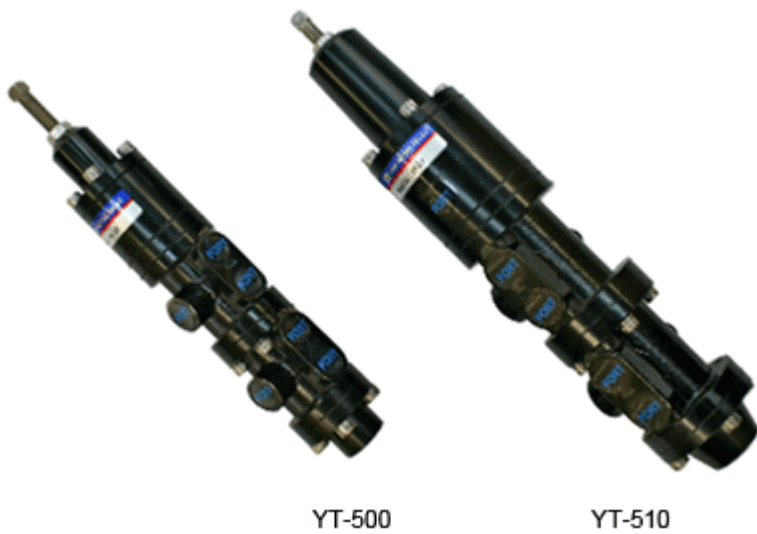

YT-500

YT-510

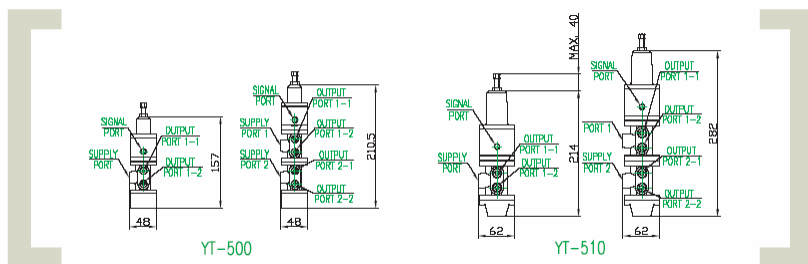

YT-500

YT-510

### Specifications

Item.Type	YT-500, YT-505	
	Single	Double
Signal	1.4~7kgf/cm <sup>2</sup>	
Max. Supply Pressure	10kgf/cm <sup>2</sup> (142psi)	
Signal Connection	PT(NPT) 1/8	
In / Out Connection	PT(NPT) 1/4	
Ambient Temp	-20 °C ~ 65 °C (-4 ~ 150 °F)	
Weight	0.8kg(1.7lb)	1.2kg(2.6lb)

Item.Type	YT-510, YT-515	
	Single	Double
Signal	1.4~7kgf/cm <sup>2</sup>	
Max. Supply Pressure	10kgf/cm <sup>2</sup> (142psi)	
Signal Connection	PT(NPT) 1/8	
In / Out Connection	PT(NPT) 3/4	
Ambient Temp	-20 °C ~ 65 °C (-4 ~ 150 °F)	
Weight	2.1kg(4.6lb)	3.3kg(7.3lb)



YT-505(SUS)

YT-515(SUS)

Snap acting relay YT-500 and YT-510 makes to change the direction of supplying air flow rate from one output port to the other port when the sensing signal pressure is lower than setting pressure.

- YT-500 and YT-510 makes to switch promptly sensing minute differential pressure correctly.
- It is able to send pressure or flow rate from device to the other device.
- It is able to lock the actuator in its last position.
- Actuator and stem is able to extend and connect.
- For special type, it is able to manufacture the stainless steel product for corrosion atmosphere or seawater.

## Solenoid Valve YT-700

Ordering Symbols: YT-700



Model	Valve Type	Connection Type	Power Source	Pressure
YT-700	<b>S</b> 3 Way	<b>P</b> PT1/4	<b>1</b> AC 110V	<b>1</b> 0~4kgf/cm <sup>2</sup> (3Way)
	<b>D</b> 4 Way	<b>N</b> NPT1/4	<b>2</b> AC 220V	<b>2</b> 0~7kgf/cm <sup>2</sup> (3 Way)
			<b>3</b> DC 24V	<b>3</b> 1.0~10kgf/cm <sup>2</sup> (4 Way)

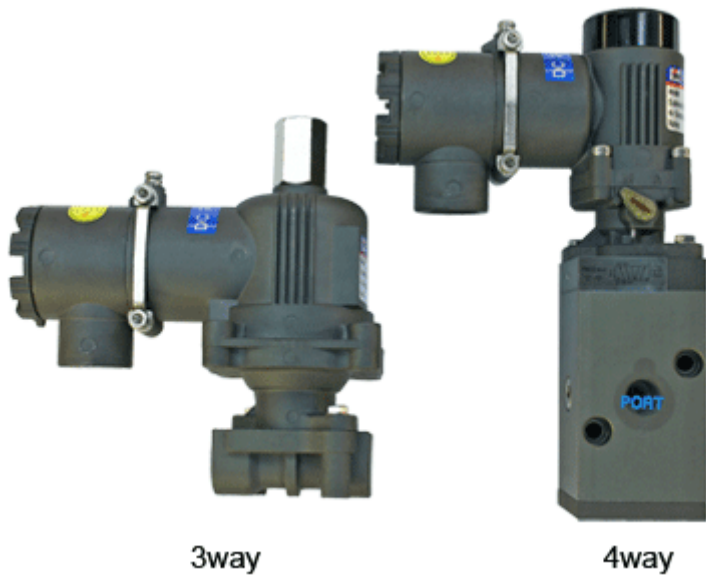

3way

4way

### Specifications

Item.Type	YT-700		
	3 Way	4 Way	
Max. Supply Pressure	0~7kgf/cm <sup>2</sup>	1.0~10kgf/cm <sup>2</sup>	
Flow Capacity(Cv)	0.084(Φ 1.6)at 4kgf/cm <sup>2</sup> 0.2(Φ 3)at 7 kgf/cm <sup>2</sup>	0.75	
Rating Current	AC 220V	100mA	63mA
	AC 110V	160mA	70mA
	DC 24V	290mA	160mA
Explosion Proof	ExdIICT6		
Connection Type	PT(NPT) 1/4		
Conduit	PF 1/2(G1/2)		
Coil Insulation Grade	ClassB		
Ambient Temp.	-20℃ ~70℃ (Operating) -20℃ ~50℃ (Explosion)		
Weight	0.8kg(1.8lb)	0.9kg(2.0lb)	

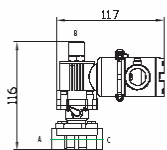

YT-700S (3 WAY)

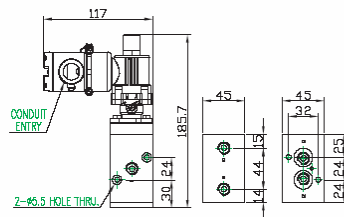

YT-700D (4 WAY)

Solenoid valve YT-700 operates opening and shutting by electrical signal of AC or DC and has explosion-proof structure.

- It is not necessary to supply lubricating oil due to special O-ring.
- Replacement is easy to design the coil of AC, DC is applicable for same Enclosure.
- Backing spring is not necessary due to usage of Balance Spool type.
- Operating test is possible when the power source is cutoff, because Manual button is attached.

## Position Transmitter PTM-5VL / PTM-5VR

Ordering Symbols: PTM-5V ■ ■ ■

Model	Actuator Motion	Explosion Proof	Lever Type	
			Linear	Rotary
PTM-5V	<span style="color: purple;">■</span> Linear <span style="color: purple;">■</span> Rotary	<span style="color: green;">■</span> Ex ia IIC T6	<span style="color: blue;">■</span> 1 10~40mm	<span style="color: blue;">■</span> 1 Standard
			<span style="color: blue;">■</span> 2 20~70 mm	<span style="color: blue;">■</span> 2 NAMUR
	<span style="color: blue;">■</span> 3 50~100 mm			
	<span style="color: blue;">■</span> 4 100~150 mm			



PTM-5VL

PTM-5VR

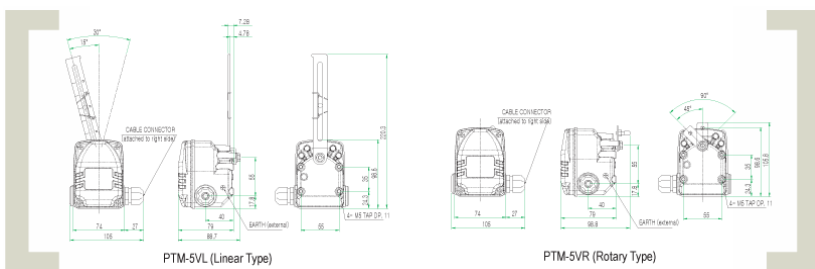

PTM-5VL (Linear Type)

PTM-5VR (Rotary Type)

### Specifications

Item.Type	PTM-5VL	PTM-5VR
Input Type	2 Wire	
Input Signal	0~30°	0~90°
Output Signal	4~20mA DC	
Impedance	Max.600Ω/28V DC	
Supply Voltage	9~28V DC	
Noise Range	50mV p.p	
Conduit	PF 1/2(G1/2)	
Protection	IP66	
Explosion Proof	ExiaIICT6	
Ambient Temp	-30℃~85℃ (Operating Temp.) -20℃~60℃ (Explosion Temp.)	
Linearity	±1% F.S.	
Hysteresis	±0.2% F.S.	
Sensitivity	±0.2% F.S	
Material	Aluminum Casting	
Weight	0.6kg(1.3lb)	

Electronic Position Transmitter PTM-5V senses mechanical position change of stem being on the valve or similar device and converses to current signal of DC4~20mA outputs.

- Compact design&durability.
- Wiring is convenient due to 2 wire type.
- It has high resolution and reliability.
- The controlling range of Zero and Span is large, so adjustment is convenient.
- It is possible to change RA/DA with changing position of dip-switch without replacement of any parts.

## Position Transmitter PTM-6VL / PTM-6VR (Flameproof Type)

Ordering Symbols: PTM-6V ■ ■ ■

Model	Actuator Motion	Explosion Proof	Lever Type	
			Linear	Rotary
PTM-6V	<span style="color: purple;">■</span> Linear <span style="color: purple;">■</span> Rotary	<span style="color: green;">■</span> ExdIICT6	<span style="border: 1px solid black; padding: 1px;">1</span> 10~40mm	<span style="border: 1px solid black; padding: 1px;">1</span> Standard
			<span style="border: 1px solid black; padding: 1px;">2</span> 20~70 mm	<span style="border: 1px solid black; padding: 1px;">2</span> NAMUR
	<span style="border: 1px solid black; padding: 1px;">3</span> 50~100 mm			
	<span style="border: 1px solid black; padding: 1px;">4</span> 100~150 mm			



PTM-6VL



PTM-6VR

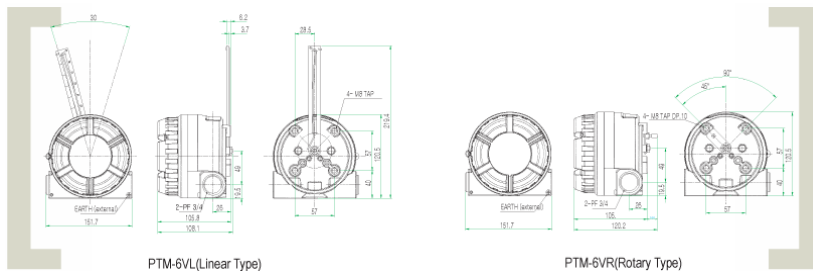

PTM-6VL(Linear Type)

PTM-6VR(Rotary Type)

### Specifications



Item.Type	PTM-6VL	PTM-6VR
Input Type	2 Wire	
Input Signal	0~30°	0~90°
Output Signal	4~20mA DC	
Impedance	Max.880Ω/30VDC	
Supply Voltage	9~30V DC	
Noise Range	50mV p.p	
Conduit	PF 3/4(G3/4)	
Protection	IP66	
Explosion Proof	ExdIICT6	
Ambient Temp	-30℃~85℃ (Operating) -20℃~60℃ (Explosion)	
Linearity	±1% F.S.	
Hysteresis	±0.2% F.S.	
Sensitivity	±0.2% F.S.	
Material	Aluminum Casting	
Weight	1.2kg(2.7lb)	

Electronic Position Transmitter PTM-6V senses mechanical position change of stem being on the valve or similar device and converses to current signal of DC 4~20mA outputs. It is flameproof type.

- Wiring is convenient due to 2 wire type.
- It has high resolution and reliability.
- The controlling range of Zero and Span is large, so adjustment is convenient.
- It is possible to change RA/DA with changing position of dip-switch without replacement of any parts.

## Position Transmitter PTM-6VR with Limit Switch (Flameproof Type)

Ordering Symbols: PTM-6VR   

Model	Option	Explosion Proof	Lever Type
PTM-6VR	 Limit Switch	 ExdIICT6	<input checked="" type="checkbox"/> Standard <input type="checkbox"/> NAMUR



### Specifications

Item.Type	PTM-6VRL	
PTM	Connection Type	2Wrie
	Input Signal	0~90°
	Output Signal	4~20mA DC
	Supply Voltage	15~30V DC
	Noise Range	50mV pp
	Conduit	PF 3/4(G3/4)
	Ambient Temp	-30 °C~85 °C (Operating) -20 °C~60 °C (Explosion)
	Linearity	±1% F.S
	Hysteresis	±0.2% F.S
	Sensitivity	±0.2% F.S
L/S	Rating	AC 0.6A 125V~16A 250V
	Swich Type	2x SPDT
Explosion Proof	ExdIICT6	
Protection	IP66	
Material	Aluminum	
Weight	1.3kg (2.9 lb)	

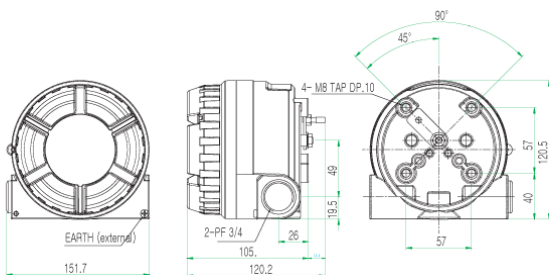

Electronic Position Transmitter PTM-6VR senses mechanical position change of stem being on the valve or similar device and converses to current signal of DC 4~20mA outputs. It is flame proof type and Limit switch is attached internally.

- Mechanical Limit Switch is built in the Position transmitter, so it is not necessary bracket for Limit switch and wiring is simple.
- Wiring is convenient due to 2 wire type.
- It has high resolution and reliability.
- The controlling range of Zero and Span is large, so adjustment is convenient.
- It is possible to change RA/DA with changing position of dip-switch without replacement of any parts.

## Limit Switch YT-850

Ordering Symbols: YT-850 ■ ■ ■

Model	Switching Type	Connection Type	Bracket Type
YT-850	<span style="border: 1px solid purple; padding: 2px;">M</span> Mechanical Type	<span style="border: 1px solid green; padding: 2px;">1</span> NPT 1/2	<span style="border: 1px solid blue; padding: 2px;">1</span> ST-1 (30*80,H20)
	<span style="border: 1px solid purple; padding: 2px;">R</span> Proximity	<span style="border: 1px solid green; padding: 2px;">2</span> PT 1/2	<span style="border: 1px solid blue; padding: 2px;">2</span> ST-2 (30*80,H30)
		<span style="border: 1px solid green; padding: 2px;">3</span> PF 1/2	<span style="border: 1px solid blue; padding: 2px;">3</span> ST-3 (30*130,H30)
		<span style="border: 1px solid green; padding: 2px;">4</span> M20	<span style="border: 1px solid blue; padding: 2px;">4</span> ST-4 (30*130,H50)
		<span style="border: 1px solid green; padding: 2px;">5</span> PG13.5	



### Specifications

Item.Type	YT-850M	YT-850P
Switch Type	Mechanical Switch x2	Proximity Sensor x 2
Switch Rating	AC:250V 3A,125V 5A DC:250V 0.2A,125V 0.4A,30V 4A	12~24V DC (Operating Voltage: 10~30v DC)
Enclosure Protection	Weather proof, IP67 / NEMA4&4X	
Ambient Temp.	-20 °C ~80 °C	
Conduit Entry	NPT1/2,(PT1/2,PF1/2,M20,PG13.5)	
Terminal	8Points	
Mouting Bracket	NAMUR VDI / VDE 3845, ISO5211	
Material	Aluminum	
Weight	880g(1.94lb)	

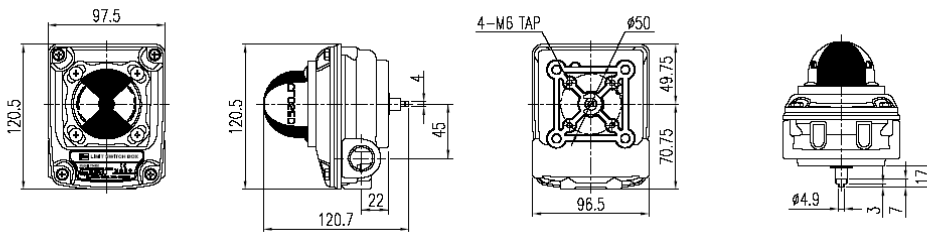

- Visual position indicator.
- Limit switch adjustment cams are splined and spring loaded, the switch cam position can be quickly adjust without tools(closed-up, open-down).
- Terminal strip number with 8 contacts is standard for micro switches.
- There are connected solenoid valve service.
- Dual 1/2" conduit entries.
- There are designed to be captive by the cover, when it removed.
- Any actuator for rotary motion can be easily mounted in ISO5211.



## Limit Switch YT-860 (Flameproof Type)

Ordering Symbols: YT-860 ■ ■ ■

Model	Switching Type	Connection Type	Bracket Type
YT-860	<span style="border: 1px solid purple; padding: 2px;">M</span> Mechanical Type	<span style="border: 1px solid green; padding: 2px;">1</span> NPT 3/4	<span style="border: 1px solid blue; padding: 2px;">1</span> D-1 (30*80,H20)
	<span style="border: 1px solid purple; padding: 2px;">P</span> Proximity	<span style="border: 1px solid green; padding: 2px;">2</span> PT 3/4	<span style="border: 1px solid blue; padding: 2px;">2</span> D-2 (30*80,H30)
		<span style="border: 1px solid green; padding: 2px;">3</span> PF 3/4	<span style="border: 1px solid blue; padding: 2px;">3</span> D-3 (30*130,H30)
			<span style="border: 1px solid blue; padding: 2px;">4</span> S-4 (30*130,H50)



### Specifications

Item.Type	YT-860M	YT-860P
Switch Type	Mechanical Switch x2	Proximity Sensor x 2
Switch Rating	AC:250V 3A,125V 5A DC:250V 0.2A,125V 0.4A,30V 4A	12~24V DC (Operating Voltage: 10~30v DC)
Enclosure Protection	Weather proof, IP67 / NEMA4&4X	
Explosion Proof	Ex d IIC T6	
Ambient Temp.	-20 °C ~60 °C	
Conduit Entry	NPT3/4(PT3/4, PF3/4)	
Terminal	8Points	
Mouting Bracket	NAMUR VDI / VDE 3845, ISO5211	
Material	Aluminum	
Weight	1.5Kg(3.3lb)	

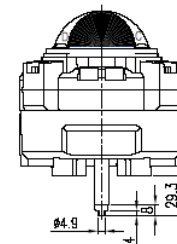
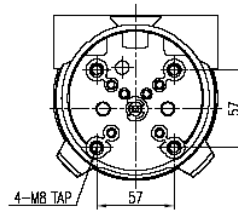
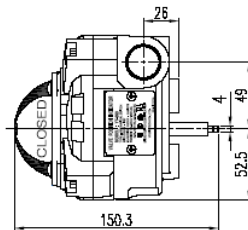
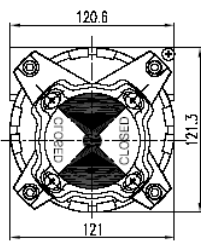

- Visual position indicator.
- Limit switch adjustment cams are splined and spring loaded, the switch cam position can be quickly adjust without tools(closed-up, open-down).
- Terminal strip number with 8 contacts is standard for micro switches.
- There are connected solenoid valve service.
- Dual 1/2" conduit entries.
- There are designed to be captive by the cover, when it removed.
- Any actuator for rotary motion can be easily mounted in ISO5211.

## Bracket, Lever

### YT-1000R Bracket Series

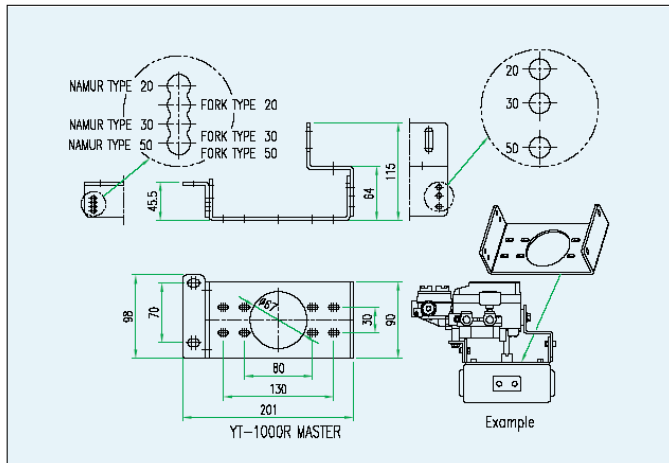

### YT-1200R Bracket Series

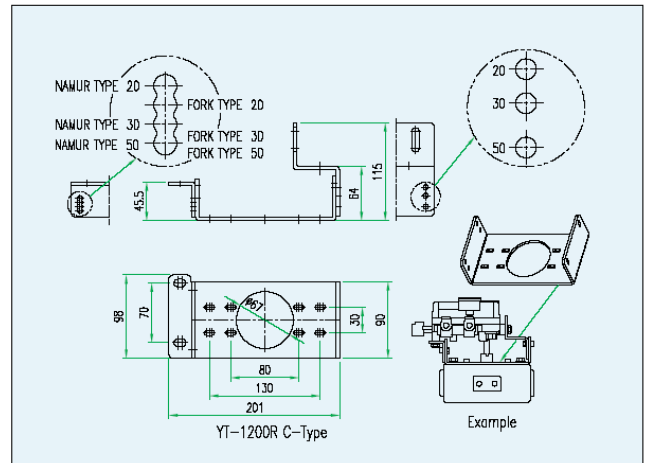

### YT-1300R & YT-2300R & YT-2400R Bracket Series

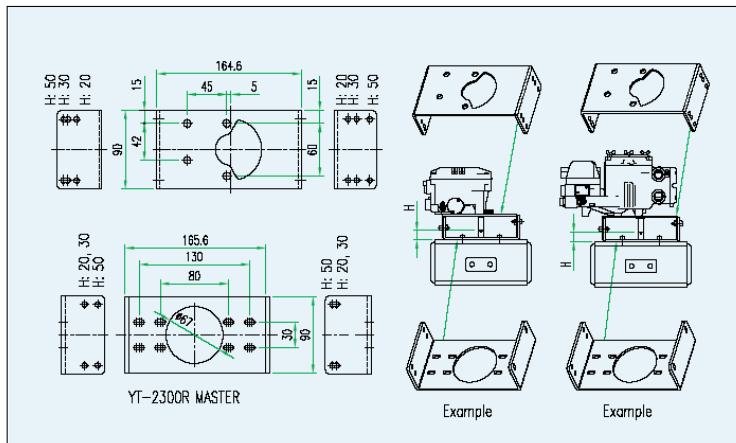

### YT-1350R & YT-2350R Bracket Series

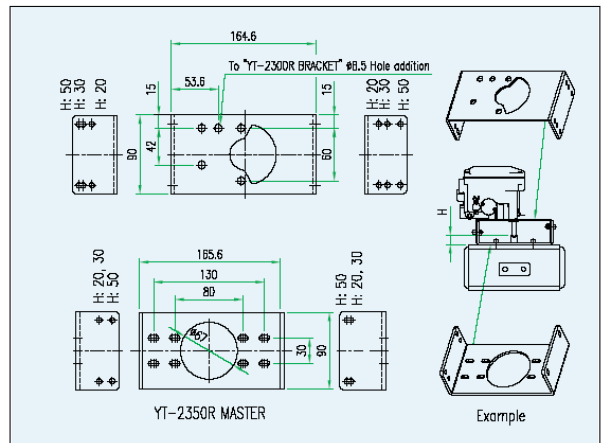

### YT-1000L & YT-1200L & YT-2300L Namur Bracket Series

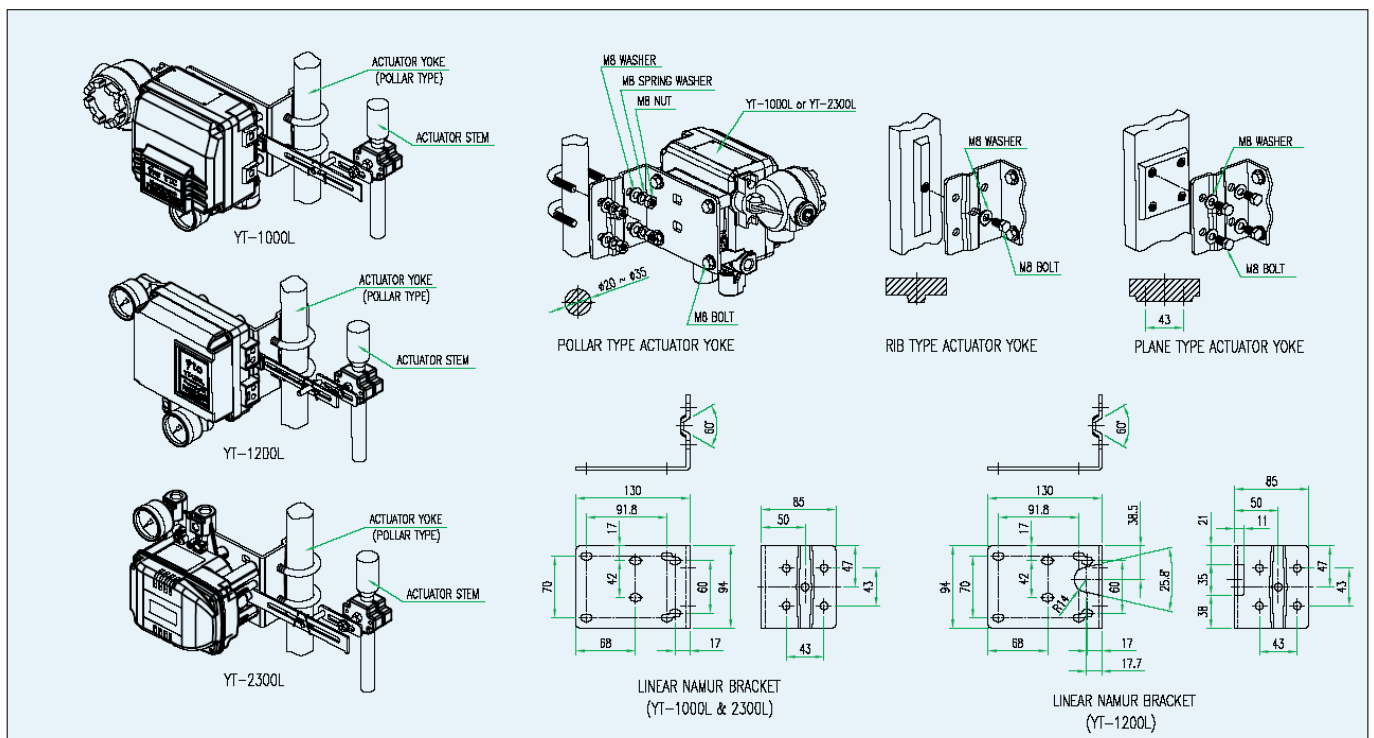

## Bracket, Lever

### Lever Series

Type 1, 2, 3

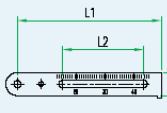

Type 4

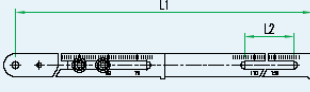

YT-1000 & 1200 Linear Type

Lever Type	Stroke(mm)	L1(mm)	L2(mm)	W(mm)
1	10~40	121.2	68.2	20.0
2	30~70	195.0	120.0	
3	60~100	277.0	122.0	
4	100~150	400.0	122.0	

Type 1, 2, 3

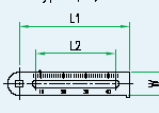

Type 4

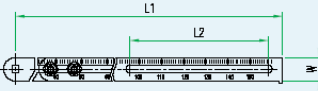

YT-1300 & 1350 & 2300 & 2301 & 2350 & 2400  
& PTM-5V & 6V Linear Type

Lever Type	Stroke(mm)	L1(mm)	L2(mm)	W(mm)
1	10~40	93.0	67.0	20.0
2	20~70	153.5	106.5	
3	50~100	214.0	117.0	
4	100~150	307.3	117.0	

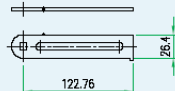

PTM-5V & 6V Rotary Type

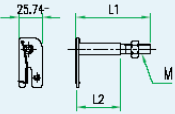

Lever Type	L1(mm)	L2(mm)	M
1	40	15	M6
2	63	37	
3	40	15	M8
4	63	37	

Rotary Type



Model	L1(mm)	L2(mm)
YT-1000, 1200	7	11
YT-2300, 2400	4	8

Namur Type

### YT-850 Bracket Series

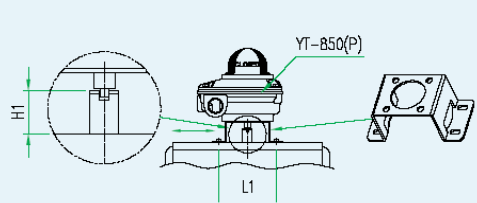

YT-850(P)

MODEL NO.	H1 (mm)	H2 (mm)	L1 (mm)	L2 (mm)	REMARK
ST-1	20	30.5	80	100	
ST-2	30	40.5			
ST-3	30	40.5	130	150	
ST-4	50	60.5			

### YT-860 Bracket Series

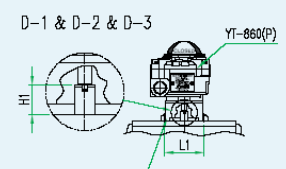

YT-860(P)

D-1 & D-2 & D-3

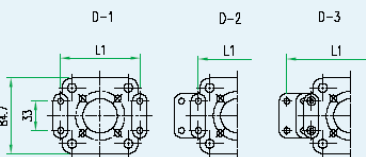

S-4

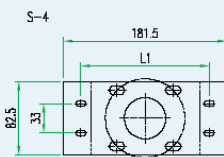

MODEL NO.	H1 (mm)	H2 (mm)	L1 (mm)	REMARK
D-1	20	42	80	
D-2	30	52		
D-3	30	52	130	
S-4	50	72		

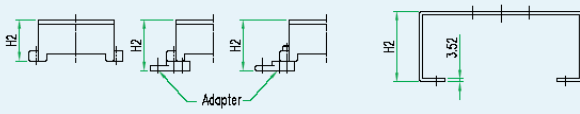

Adapter



## Yong Tech Co. , Ltd.

ADD : 662-8, Pungmu-Dong, Kimpo-City, Kyeonggi-Do, Korea  
TEL : 0082-31-986-8545  
FAX : 0082-31-986-2683  
E-mail : [ytic@ytic.co.kr](mailto:ytic@ytic.co.kr)  
Homepage : <http://www.ytic.co.kr>

This information contained in this catalogue is subject to change without prior notice  
Please contact our web-site for the latest information.

Printed by 2006.04.20